

North Texas Regional Airport West Side Hangar



28,275 sq. ft.//up to 200 acres



See reverse for details

West Side Hangar

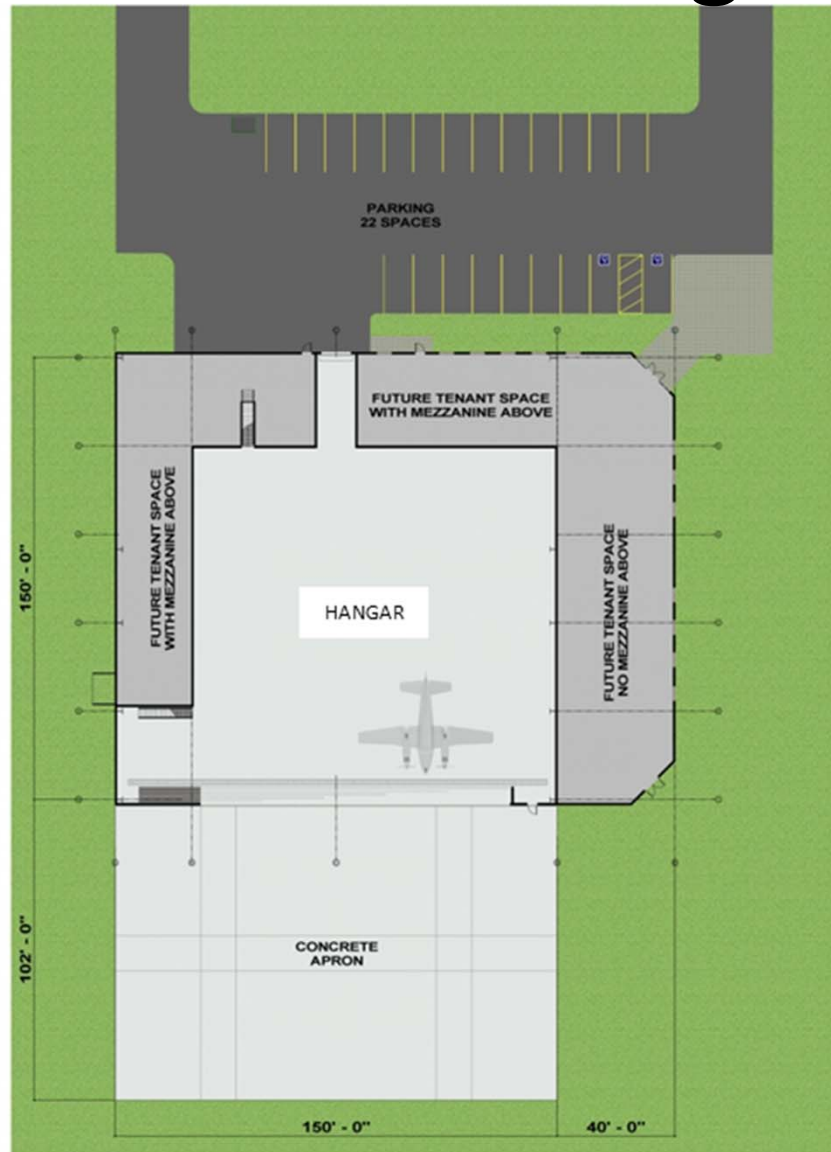

- This new 28,275 sq. ft. hangar is located next to Taxiway B to the west of our 9,000' 17L/35R runway and immediately adjacent to S.H. 289 (Preston Trail Highway) accessed from our West gate
- There are approximately 200 acres of developable land, with utilities, adjacent to this hangar
- The 150' X 150' hangar bay includes a motorized 118' X 28' hangar door
- On the east side of the hangar bay is 6,000 sq. ft. of office area ready to be finished out to your specifications
- There is another 6,000 sq. ft. of shop/office area underneath a concrete mezzanine, which may be configured for storage or additional office space
- Hangar comes with a concrete vehicle parking area and access road from S.H. 289
- There is ample aircraft ramp space (23,625 sq. ft.) in front of the hangar
- Taxiway B between the West Side Hangar and Runway 17L/35R has recently been resurfaced and striped