

GRAVISON COUNTY
VOLUNTARY COUNTY
DISTRICT

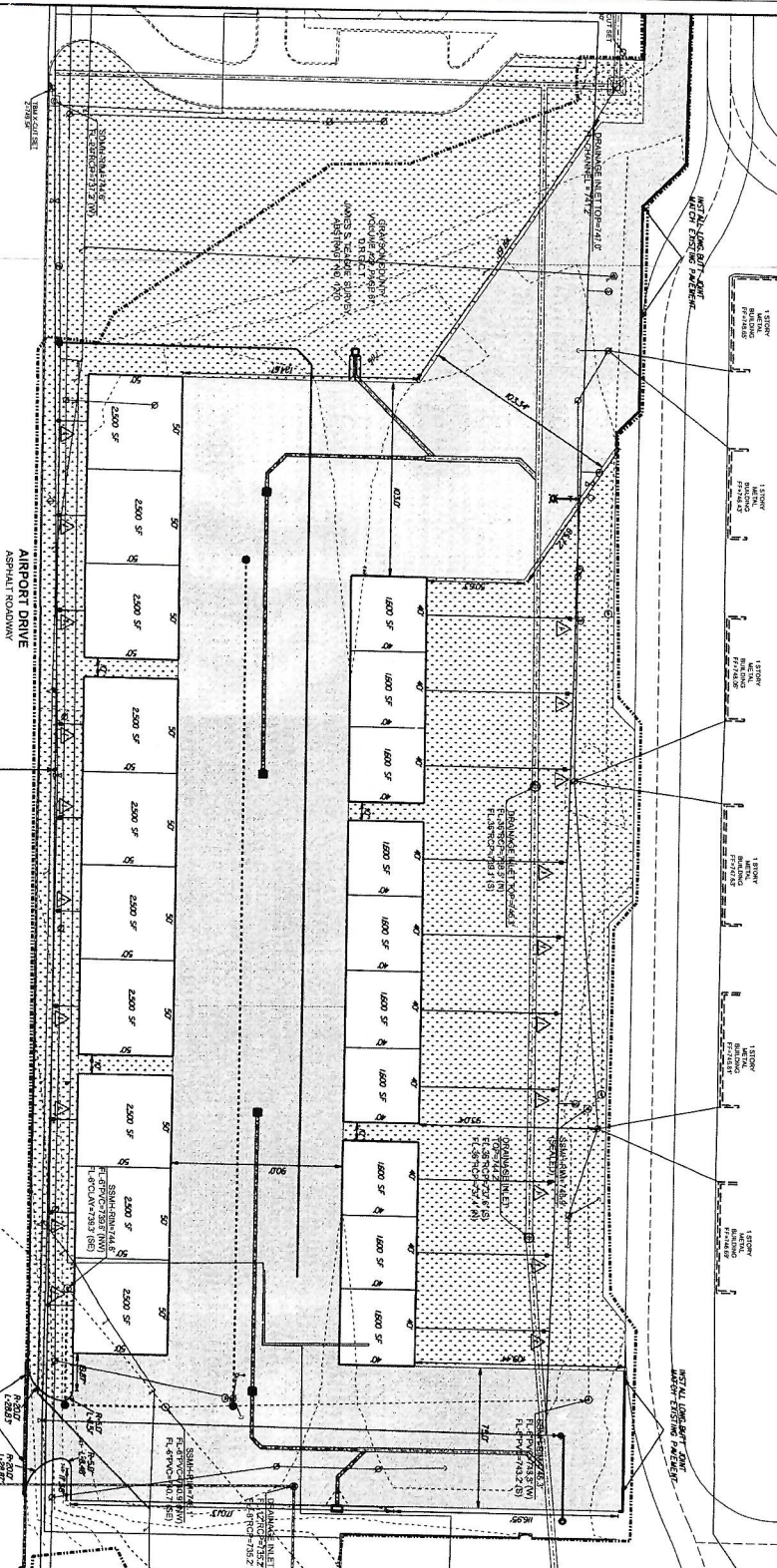
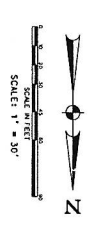

LINE LEGEND:

- EXISTING CENTER LINE
- EXISTING RIGHT OF WAY LINE
- EXISTING STREET CENTER LINE
- EXISTING STREET RIGHT OF WAY LINE
- EXISTING SIDEWALK CENTER LINE
- EXISTING SIDEWALK RIGHT OF WAY LINE
- EXISTING DRIVE CENTER LINE
- EXISTING DRIVE RIGHT OF WAY LINE
- PROPOSED CENTER LINE
- PROPOSED RIGHT OF WAY LINE

GENERAL NOTES:
ALL DIMENSIONS ARE TO BACK OF CURB
ALL CURBS ARE 3" MAXIMUM CURBS
PAVEMENT SECTIONS:
1" 4,400 PSI CONCRETE T. REINFORCED WITH #4 BARS ON 18"
OVER 6" 4,400 PSI CONCRETE T. REINFORCED WITH #4 BARS ON 18"
OVER 6" 4,400 PSI CONCRETE T. REINFORCED WITH #4 BARS ON 18"
OVER 6" 4,400 PSI CONCRETE T. REINFORCED WITH #4 BARS ON 18"
REFER TO STRUCTURAL FOR SLAB DETAILS

WATER METER SCHEDULE

ID NUMBER	TYPE	SIZE	REMARKS	DATE
1	DOMESTIC	1"	20' - IMPROVED	6"

OWNER / OPERATOR:
TEXARK AIR DRIVE
2108 S. ALHAR DRIVE
MRS. DON CALAHAN
(214) 325-1870

ENGINEER:
HELMBERGER ASSOCIATES, INC.
125 BERGWAY ROAD
WYLIE, TEXAS 75098
MR. RANDALL T. HELMBERGER, P.E.
(972) 442-7459

SITE PLAN / IMPROVEMENTS

3.94 ACRES - TRACT 3
NORTH TEXAS REGIONAL AIRPORT
DENISON, TEXAS

HELMBERGER ASSOCIATES, INC.
307 NORTH DALLAS STREET, SUITE 1000
DALLAS, TEXAS 75201
TEL: (214) 750-1111

DATE	SCALE	NOTES	FILE	NO.
08/07/08	1"=30'		234	C1